

**Technical Note No. 060****AQSync Gill Weather Station Installation**

**Date:** 08 August 2024

**Author:** Luke Greenidge

**Summary:**

This Tech Note describes installing the Gill Weather Station mounting hardware. Contact [techsupport@2BTech.io](mailto:techsupport@2BTech.io) for questions regarding this procedure.

**Tools/Materials Needed:**

1 x t40 tamperproof screwdriver

1x 9/16" wrench or socket wrench

1x Adjustable wrench

1 x PH #3 screwdriver

1x PH #2 screwdriver

1 x Hardware mounting kit

1x 3/16" Allen Key

**Important Note:** The software will need to be updated or modified for data collection and transmission. Contact [techsupport@2BTech.io](mailto:techsupport@2BTech.io) for details.

## Procedure:

1. Unplug the AQSync from all power sources.
2. Remove the fastener plugs from the left side of the enclosure. **Keep the nuts and internal washers for installing the pole mounting bracket**; the sealing rubber washers are not needed. The nuts are 9/16", the fasteners are either PH #3 or t40.



3. Remove the blank weather station power/COM connector by unscrewing the nut on the outside of the enclosure. This can be removed with an adjustable wrench. Remove the piece on the inside of the enclosure.



4.

a) Install the 1-7/8" pipe mounting bracket on the outside of the enclosure using 3x each of:

- 3/8-16 2" Torx screws
- 3/8"x1" large Aluminum spacers
- 3/8" SS split washers
- 7/8"OD flat washers [11-763]
- 3/8"-16 SS nuts

Important: The split washer goes between the bracket and the screw head on the top two screws (red circle) but on the bottom (lower) screw, it goes on the inside between the nut and flat washer (blue circle). This is giving the clearance needed on both sides to allow the power supply to sit straight and the weather station pole to slide down.



- b) Install the USB side of the cable in the enclosure. Use an adjustable wrench to secure the nut. The USB is plugged in at a later step.

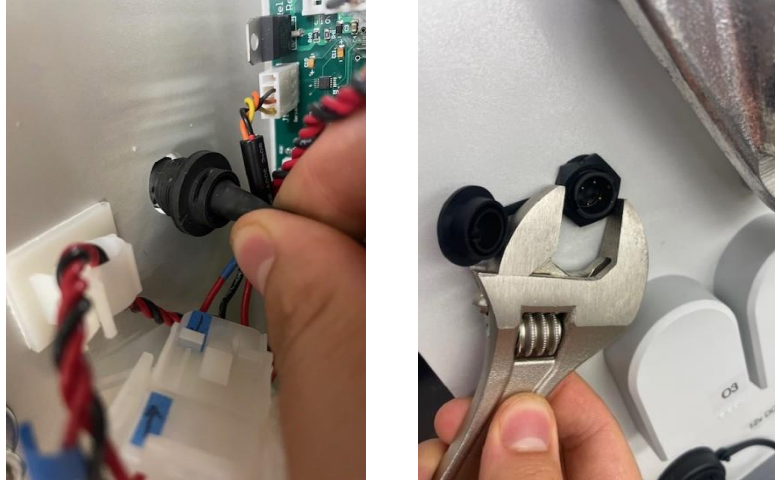

- c) Plug the cable into the weather station and route the end of the cable down the machined mounting pipe (1-3/4" OD). Use 3x 10-32 1/2" screws to attach the weather station to the mounting pipe's 3 machined holes (red circles below).



- d) Mount the weather station and mount the pipe into the pipe mounting bracket using a 3/16" allen key and the two set screws in the mount (yellow box in photo).



- e) Plug the USB cord into any slot on the USB hubs underneath the touchscreen.

